

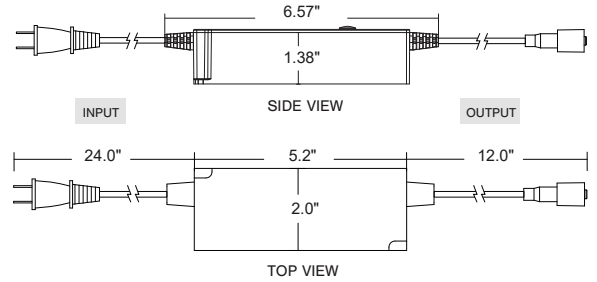

iQ-ND-50-65

iQ-ND-50-65 is Q-Tran's interior or exterior rated, easy to use power supply. The iQ-ND-50 comes ready for installation with an AC input cord for easy plug in to standard wall outlets, and with a wet rated barrel connector on the DC output for easy and fast installation. The power supply is rated IP65 and is capable of power up to 50W of load. The driver is a non-dimmable, 24VDC constant voltage output. This easy to use driver is great for those simple jobs that need a simple, high quality, low cost solution.



FEATURES

- Limited output voltage and current, plus isolation for safe operation
- Fully potted driver(s) for moisture resistance
- Surface mount only
- Suitable for dry, damp and wet locations
- Suitable for Indoor or Outdoor use
- Primary Voltage - Universal (120-277V)
- Wide operating temperature range: -40 degF to +140 degF
- Class 2
- UL Listed
- 5 year warranty

PERFORMANCE

- : Rated for surface mount
- : Fully rated to operate low voltage load at listed wattage (No Derating Required)
- : Voltage regulation to 2% or less of rated output voltage
- : Universal input range of 120-277 Vrms
- : Short circuit protection (SCP)
- : Over voltage protection (OVP)
- : Over current protection (OCP)
- : Live tested by manufacture to ensure proper operation
- : Manufacturer offers minimum of 5 year warranty

WIRE LENGTH TABLE

VOLTAGE DROP CHART										
VDC	Watts (W)	10 AWG (5.6mm ²)	12 AWG (3.3mm ²)	14 AWG (3.0mm ²)	16 AWG (1.3mm ²)	18 AWG (0.78mm ²)	20 AWG (0.50mm ²)	22 AWG (0.33mm ²)	24 AWG (0.20mm ²)	26 AWG (0.13mm ²)
24	17	897'	564'	355'	223'	140'	88'	55'	35'	22'
	25	567'	356'	224'	141'	88'	56'	35'	22'	14'
	40	309'	194'	122'	77'	48'	30'	30'	12'	7'
	80	130'	82'	51'	32'	20'	13'	8'	5'	3'
	100	84'	53'	33'	21'	13'	8'	5'	3'	

*Distances are based on a 5% Voltage drop max.

- This product must be installed in accordance with the applicable installation code by a person familiar with the construction and operation of the product and the hazards involved
- If dimming with optional 0-10V dimming module, use a dimmer rated for 0-10V operation

SPECIFICATIONS

*- 200us event

Input			
• Input Voltage (Vrms)	90-305		
• Input current, max (Arms)	0.63		
• Inrush Current, max* (Apk)	30		
• Input Frequency (Hz)	47-63		
• Input Power (W)	57		
Output			
• Output Voltage, nom (V)	24		
• Output Current (A)	4.0		
• Output Power (Wmax)	50		
Environmental	Min	Nom	Max
• THD (%)	----	----	2.0
• PF (%)	0.90	----	----
• Case Temp (°C)	----	----	70
Protections	Compliance		
• Short Circuit Protection (SCP)	• EMI/RFI : ISPR-22 Class B		
• Over Voltage Protection (OVP)	: IEC 61547		
• Over Current Protection (OCP)	: IEC 61000-3-2		
• Class I, Class II Output	: IEC 61000-3-3		
• IP65	: EN 55015		
	• Certified : UL/cUL 1012/1310/1585		
	: UL-879		
	: UL-8750		

ORDERING GUIDE

1	2	3
Model	Max Output (W)	IP Rating
iQ-ND	50	65
1 Model		
iQ-ND: NonDim		
2 Max Output		
50: 50W		
3 IP Rating		
65: IP65		
Ordering Example		
iQ-ND-50-65		

2020-02-10-V1

PROJECT NAME	DATE	COMPANY	TYPE	NOTE



iQ-ND-50-65

SPECIFICATIONS

Power Factor Characteristic (24V)

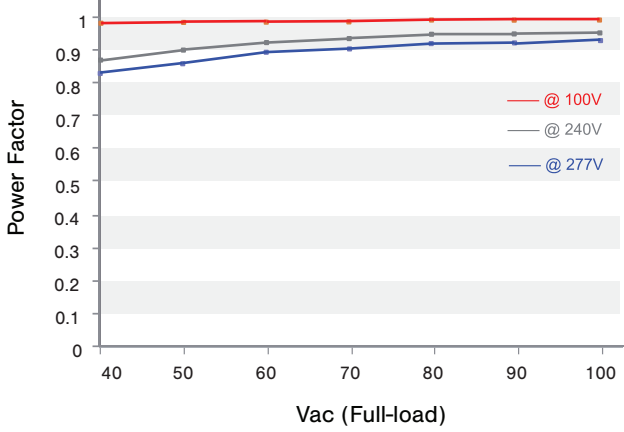

Efficiency vs. Load (GLV50 24 Model)

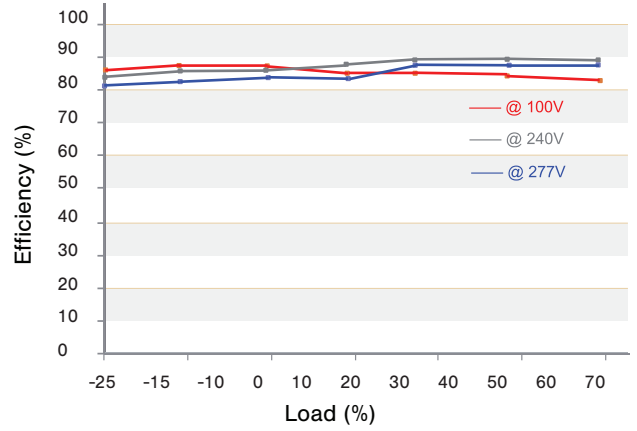

Loading Curve

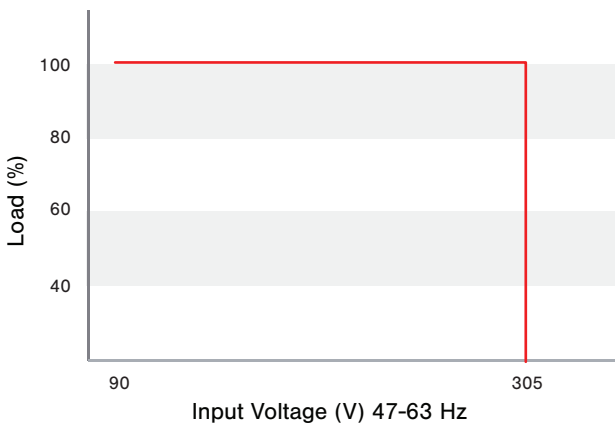

Derating Curve (SWI)

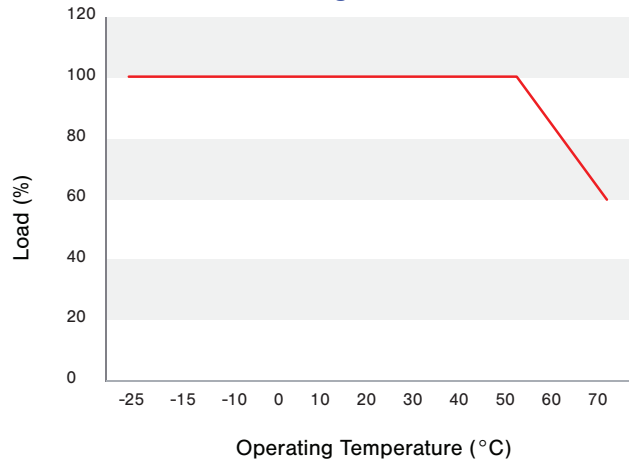

Derating Curve (SWO)

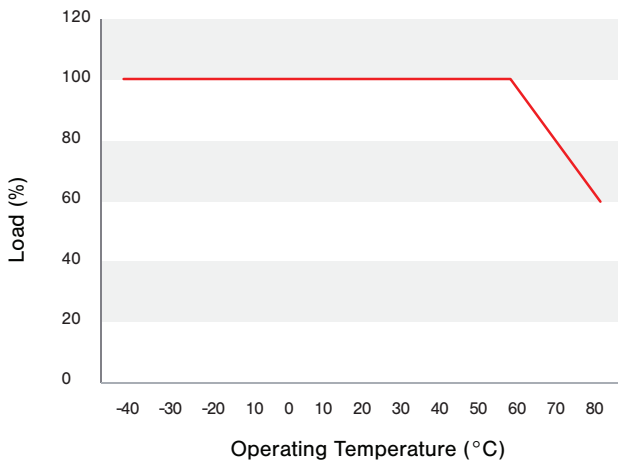



iQ-ND-50-65

WIRING DIAGRAM

CONNECTORS

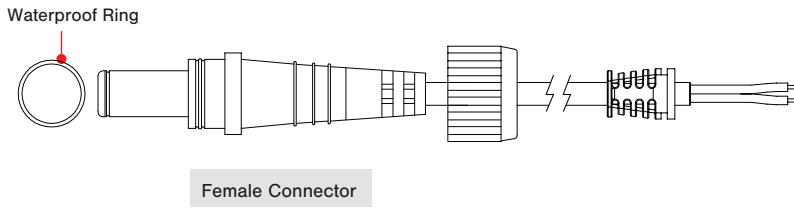

WIRING INSTALLATION

