

RESOURCE GUIDE

EXTRUSIONS - SURFACE - SLIM

Model: iQA



FINISH

SATIN



SATIN ANODIZED
MATTE FINISH
METALLIC ENDCAPS

BLACK



BLACK ANODIZED
MATTE FINISH
BLACK ENDCAPS

BRONZE



BRONZE ANODIZED
MATTE FINISH
BRONZE ENDCAPS

MOUNTING TYPE - SURFACE

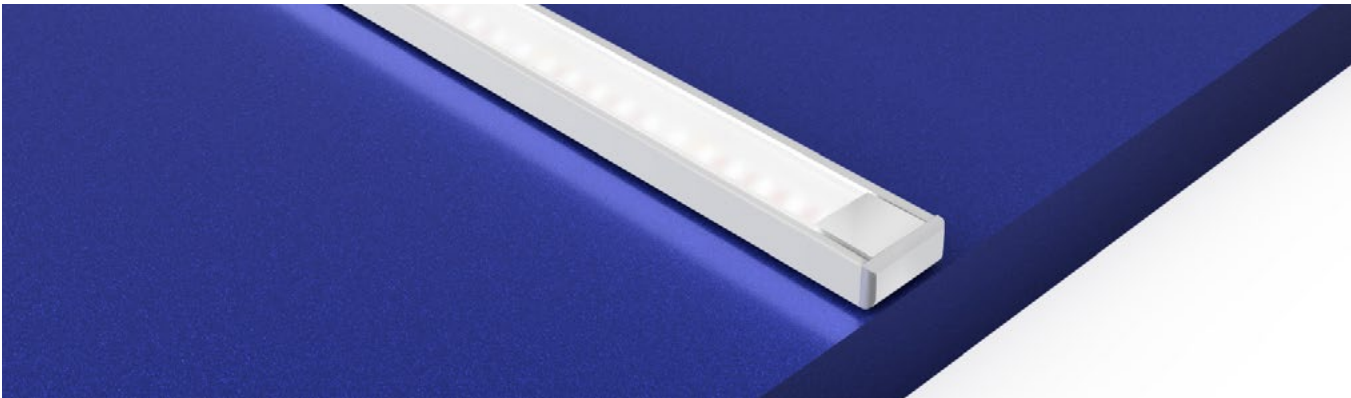

MOUNTING - HARDWARE

Stainless Steel Clip (SST)

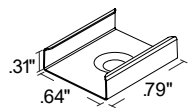

2 clips provided for 4' or less;
4 clips provided for greater than 4'

- Stainless Steel
- Indoor/Outdoor
- #4 x 5/8" Flat Head SS (1 per clip included)

VHB-STD & VHB-CON (see Accessory cutsheet)

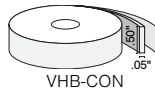
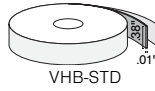

- Double sided strong adhesive tape
- VHB-STD is for Indoor use
- VHB-CON bonds to concrete

832 (see Accessory cutsheet)



- Strong adhesive
- Not submersible, For dry and wet locations only

Q-ANGLE (see Accessory cutsheet)

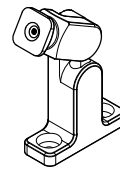

- Adjustable mounting bracket
- Indoor/Outdoor

PIVOT BRACKET (see Accessory cutsheet)

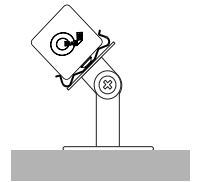

- Adjustable mounting bracket
- Indoor

LENS

CL Clear

DF Diffused



CUT OFF

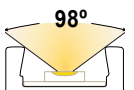

Clear 98°

RESOURCE GUIDE

EXTRUSIONS - SURFACE - SLIM

Model: iQA



CONNECTORS/WIRE

STATIC WHITE AND STATIC COLOR ONLY

LIGHT ORIENTATION

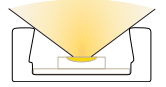
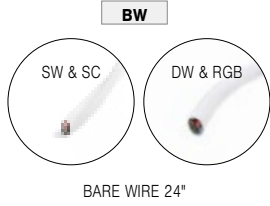

SYMMETRICAL

TYPE To order a bare extrusion without a strip installed in Q-Tran factory, choose **NI** (Not Installed) for your Type option

